



Instructions for Rewiring the ADU-42CF Pump Wiring Harness

SAFETY PRECAUTIONS
Warning - Improper application, adjustment, or servicing can result in serious injury. Always disconnect power source before servicing.

The Pump Wiring Harness, P/N 875095, on the ADU-42CF Sink may have been mis-wired on some units. The black and white wires in connector P/N 860018 may have been reversed, which can cause reduced water flow through the solenoid valve.

These instructions enable a technician in the field to correct this reduced water flow by reversing the black and white wires in the wire connector. Follow the steps below:

Wiring Removal

- 1** Disconnect the ADU-42CF Sink power source. Refer to disassembly instructions on pages 11-13 of the ADU-42CF Service Manual, PN 420752, and remove the sink spout and chassis.

Locate the PC Board Assembly on the right side of the water tank and detach the white 3-Wire Connector, PN 860018, from the 'J3' 3-pin receptacle on the Board (Fig. 1).

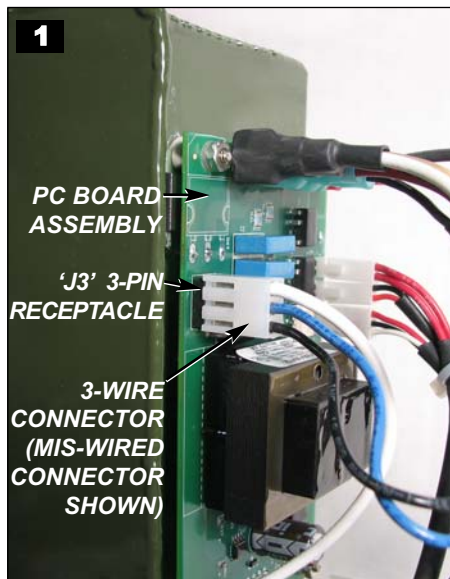

- 2** Locate the #1 pin indicator which is molded into the plastic end of the white 3-wire connector (Fig. 2). If the Black Wire is installed in this #1 location, it must be removed and swapped with the White Wire from the #3 pin location. Proceed to steps 3-6 to reverse these two wires.

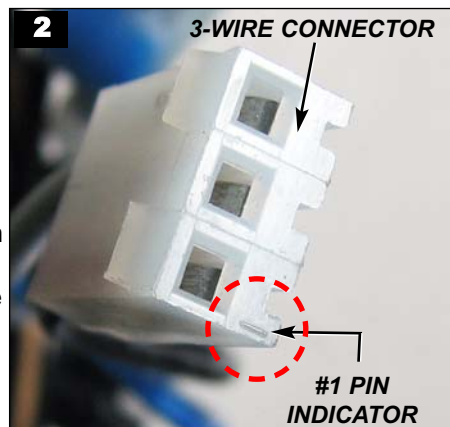

- 3** Insert a small, thin screwdriver into the #1-pin slot located on the side of the 3-Wire Connector and gently press inward on the locking tab on the metal wire terminal inside the connector (Fig. 3). At the same time, pull the Black Wire/terminal out of the Connector. Repeat this procedure for the White Wire at the #3-pin position.

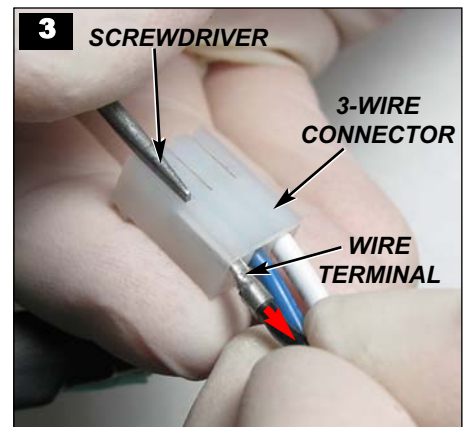

- 4** After the Black and White Wires have been removed from the 3-Wire Connector, the locking tab on each wire terminal should be bent back to their original positions, to assure they reseat properly in the Connector when reinstalled. Use the small screw-driver to pry or push the tabs outward, as shown in Fig. 4.

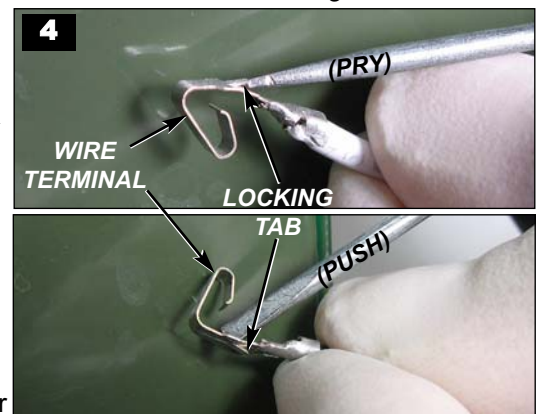

Cont'd on back side...

ReWiring

- 5** Reinsert the White Wire into the position #1 of the 3-wire connector, with the slot on the connector and the locking tab on the wire terminal both facing upward, as shown in Fig. 5.

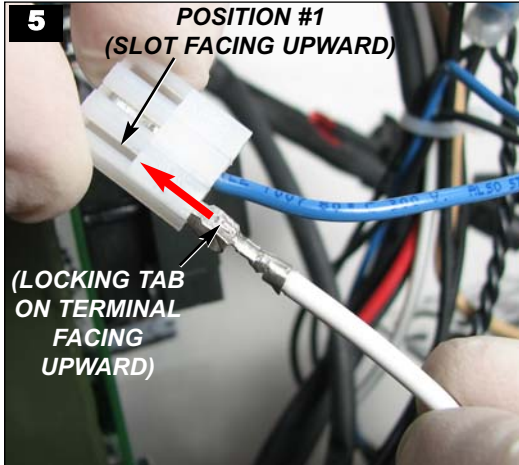

- 6** Repeat the procedure above in Step 5 for the Black Wire (Fig. 6). Assure that the black, white, and blue wires are secured firmly into the 3-Wire Connector.

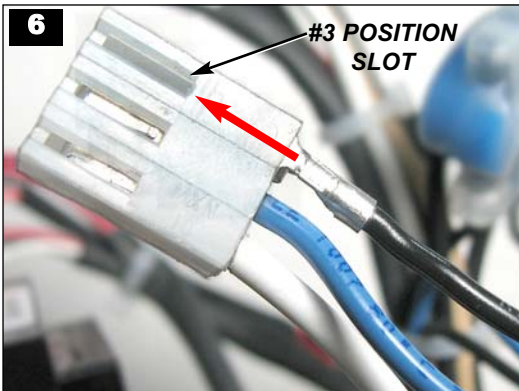

- 7** Reinstall the 3-Wire Connector onto the 'J3' 3-pin receptacle located on the PC Board, as shown in Fig. 7.

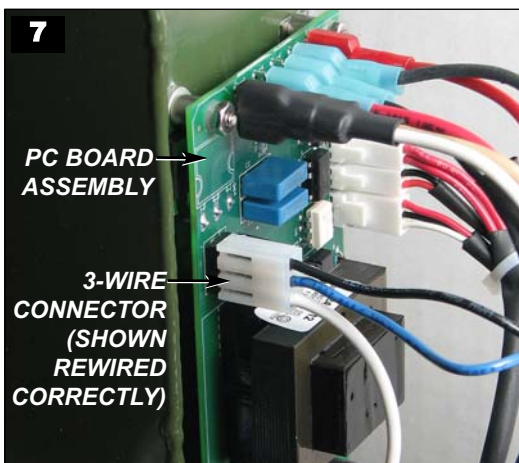

**THIS COMPLETES THE REWIRING OF THE
ADU-42CF PUMP WIRING HARNESS.**

Rewiring Parts List

<u>Part Description</u>	<u>Part Number</u>	<u>Qty</u>
Connector, 3 Pin .156 Hsng	.860018	1
Terminal, .156 Crimp 18-24 AWG	.860033	3



P.O. Box 1548 Woodinville, WA 98072
8333 216th Street SE Woodinville, WA 98072
(425) 487-3157 (800) 426-5913
www.aseptico.com • info@aseptico.com

P/N: 421060 • Rev. A • ECO 13321 03/14
PRINTED IN THE U.S.A.